

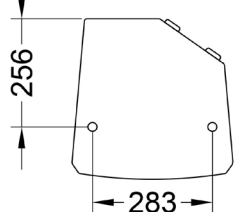

Z 120

FULL-RANGE PASSIVE SPEAKER

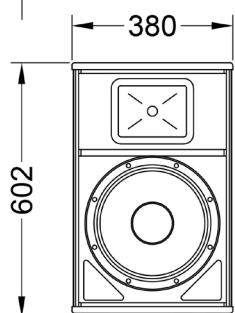
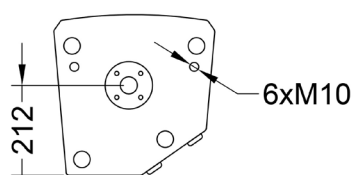
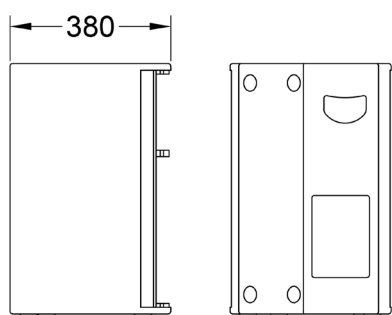

Main features:

- 250W nominal power
- 12" woofer with 2" voice coil
- 1" HF driver with 1,5" voice coil
- 126 dB Max SPL
- Stage monitoring ready enclosure

Frequency Response (-10dB)	60 - 18000 Hz
Max SPL (peak)	126 dB (calculated)
Sensitivity (1W/1m)	96 dB
LF Transducer	12"
HF Transducer	1"
Nominal coverage HxV	60° x 40°
Impedance	8 hm / 4 Ohm
Nominal power	250 W
Program power	500 W
Peak power	1000 W

Connectors	2x Neutrik Speakon
Dimensions (WxHxD)	380x602x380 mm
Net weight	21 kg
Shipping weight	24 kg
Mounting	10x M10 flying points Pole mount adapter
Enclosure materials	Plywood; MDF; wear-resistant paint
Grill	Steel grill, polymer protective net

Acoustical & Electrical data

Connections, physical data
and exploitation